

**SPECIFICATION:**

Maximum length (including swim platform and bow pulpit).....22.07M(72'-5")  
 Hull length (including swim platform).....22.02M(72'-3")  
 Maximum Beam.....5.05M(16'-7")  
 Fuel Tank Capacity.....4000L (1,057 U.S. GAL)  
 Fresh Water Tank Capacity.....1,000L(264 U.S. GAL)  
 Engine.....Cat. C-12 Acert 705bhp x 2

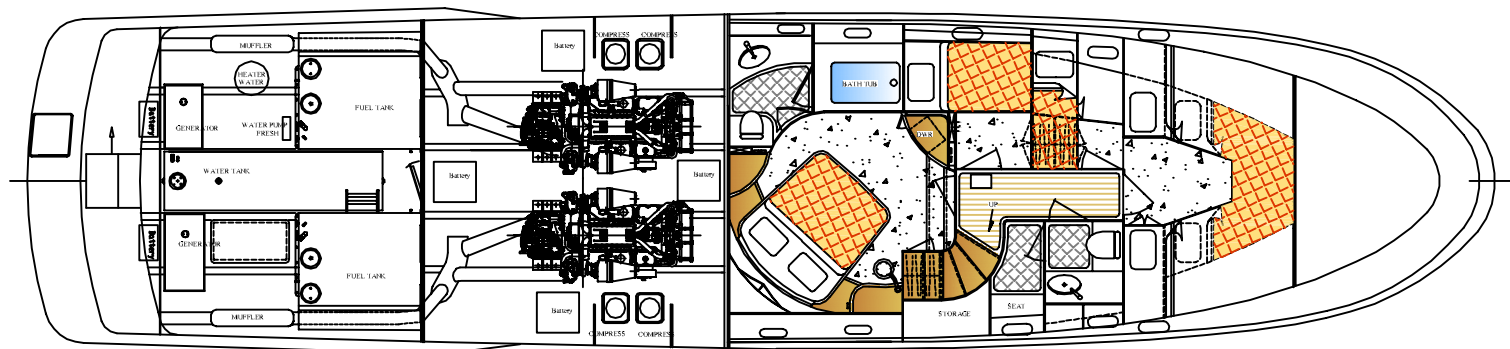
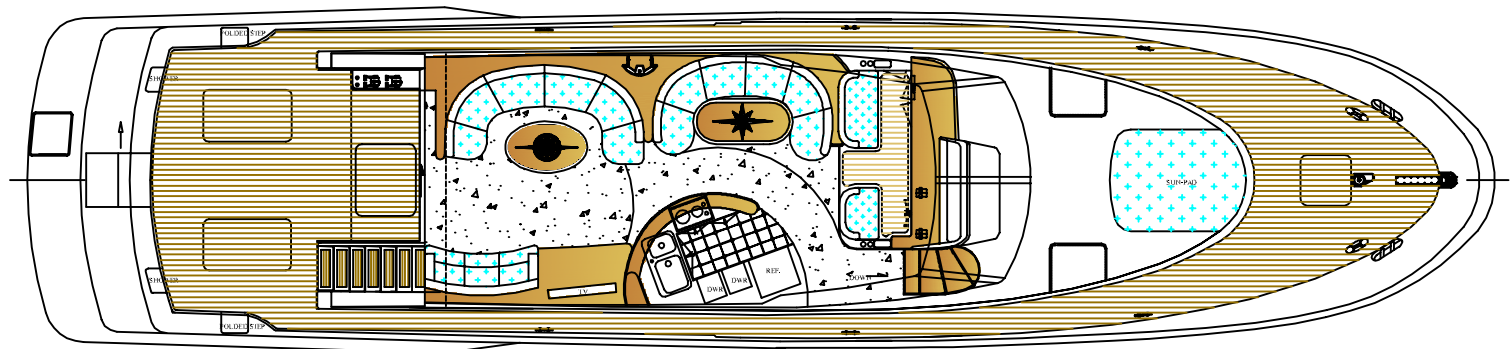
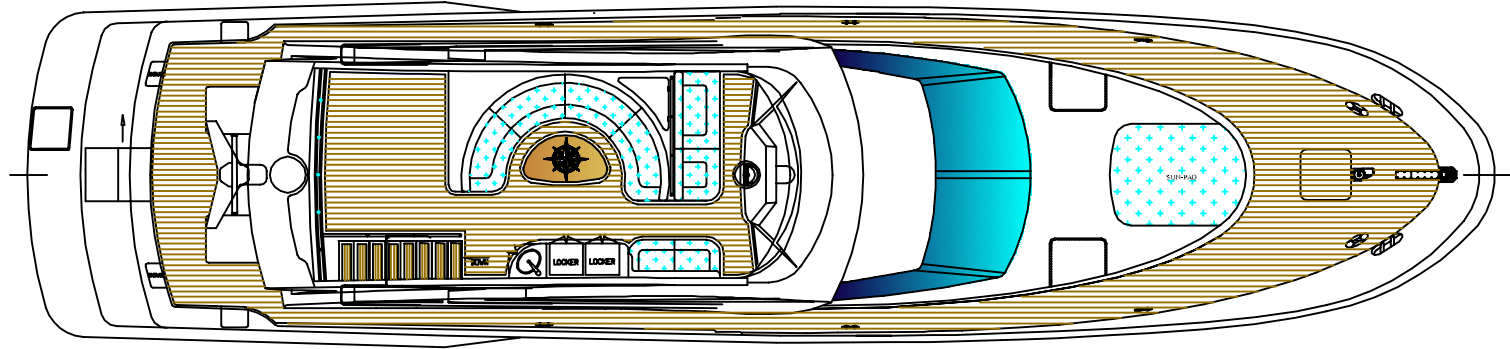

**President 720 Convertible**

ALL SPECIFICATIONS & EQUIPMENT SUBJECT TO CHANGE WITHOUT NOTICE  
 DRAWINGS MAY SHOW OWNER OR DEALER INSTALLED OPTIONS  
 THIS DRAWING AND THE INFORMATION CONTAINED HEREON IS AND REMAINS THE PROPERTY OF PRESIDENT BOAT INTERNATIONAL CO., LTD. ITS REPRODUCTION IN ANY WAY OR USE FOR ANY PURPOSE OTHER THAN THAT INTENDED IS EXPRESSLY FORBIDDEN

Profile & General Arrangement
Drawing No.: P720C-001
Date: Dec. 04, 2009
President Boat International Co., Ltd. Taiwan